

PRODUCT DATA SHEET

INSULATED SPADE TERMINALS



DESCRIPTION

Insulated Spade Terminals are used to connect or terminate a single wire while connected to a stud or screw type used for electrical connection.

FEATURES

- | | |
|-------------------------|----------------------------------|
| - Standard | : DIN 46237 |
| - Material | : Copper, Tin Plated |
| - Insulation | : PVC |
| - Operating Temperature | : Maximum From 105° to 600 Volts |

MARKINGS



- It complies with RoHS standards.
- It complies with UKAS Quality Management standards.
- It complies with CE standards.
- It complies with UL standards.

PRODUCT DATA SHEET

INSULATED SPADE TERMINALS

SECTIONS AND DIMENSIONS

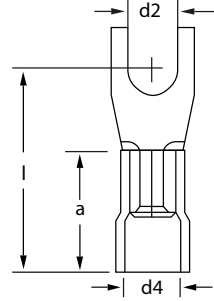

PRODUCT CODE	COLOUR	CABLE SECTION (mm ²)	BOLT SIZE	DIMENSIONS (mm)					
				d2	d3	i	d1	d4	a
GCU - 3001	Red	0.50 - 1.50 mm ²	M3	3.2	6.0	16.0	1.6	4.0	10.0
GCU - 4001	Red		M4	4.3	8.0	17.0	1.6	4.0	10.0
GCU - 5001	Red		M5	5.3	10.0	18.0	1.6	4.0	10.0
GCU - 6001	Red		M6	6.5	11.0	20.0	1.6	4.0	10.0
GCU - 3002	Blue	1.50 - 2.50 mm ²	M3	3.2	5.5	18.0	2.3	4.5	10.0
GCU - 4002	Blue		M4	4.3	6.8	17.0	2.3	4.5	10.0
GCU - 5002	Blue		M5	5.3	10.0	19.0	2.3	4.5	10.0
GCU - 6002	Blue		M6	6.5	11.0	21.0	2.3	4.5	10.0
GCU - 4006	Yellow	4.00 - 6.00 mm ²	M4	4.3	8.0	21.0	3.6	6.3	13.0
GÇU - 5006	Yellow		M5	5.3	10.0	22.0	3.6	6.3	13.0
GCU - 6006	Yellow		M6	6.5	11.0	23.0	3.6	6.3	13.0
GCU - 8006	Yellow		M8	8.4	14.0	26.0	3.6	6.3	13.0